

# Spreader

## X4s

A spreader is one of the most important tools of a rescuer. Strangely enough it is one of the most misunderstood tools. When purchasing a spreader many make decisions on maximum force and opening. Please don't, as that is not why you buy a spreader! Let us explain further: A spreader is used to open structures with a small gap or opening. You need progressive power at the beginning of your spreading action, as that is where a structure is toughest and the opening is at its smallest – not at the end of the spread. Furthermore a spreader can easily be designed to have a 90-degree angle for a very large opening, but above 63-degrees a spreader will start to pull itself into the structure instead of spread. It is all about effective performance and doing the job the best, not just what looks good on paper. Compared to the X4, the X4s has pointier jaws and a larger opening for when more space is required. The Spreader X4s is the highest performing spreader on the market if you know what you're looking for.

#### Features:

- UltimatePressure
- EWOtechnology

#### Facts:

- Best power to weight ratio
- Most powerful spreader on the market
- Progressive power line at the start

**EWO**  
TECHNOLOGY  
**PRESSURE™**  
**ULTIMATE**

X4s Spreader: the highest performing spreader if you know what you're looking for

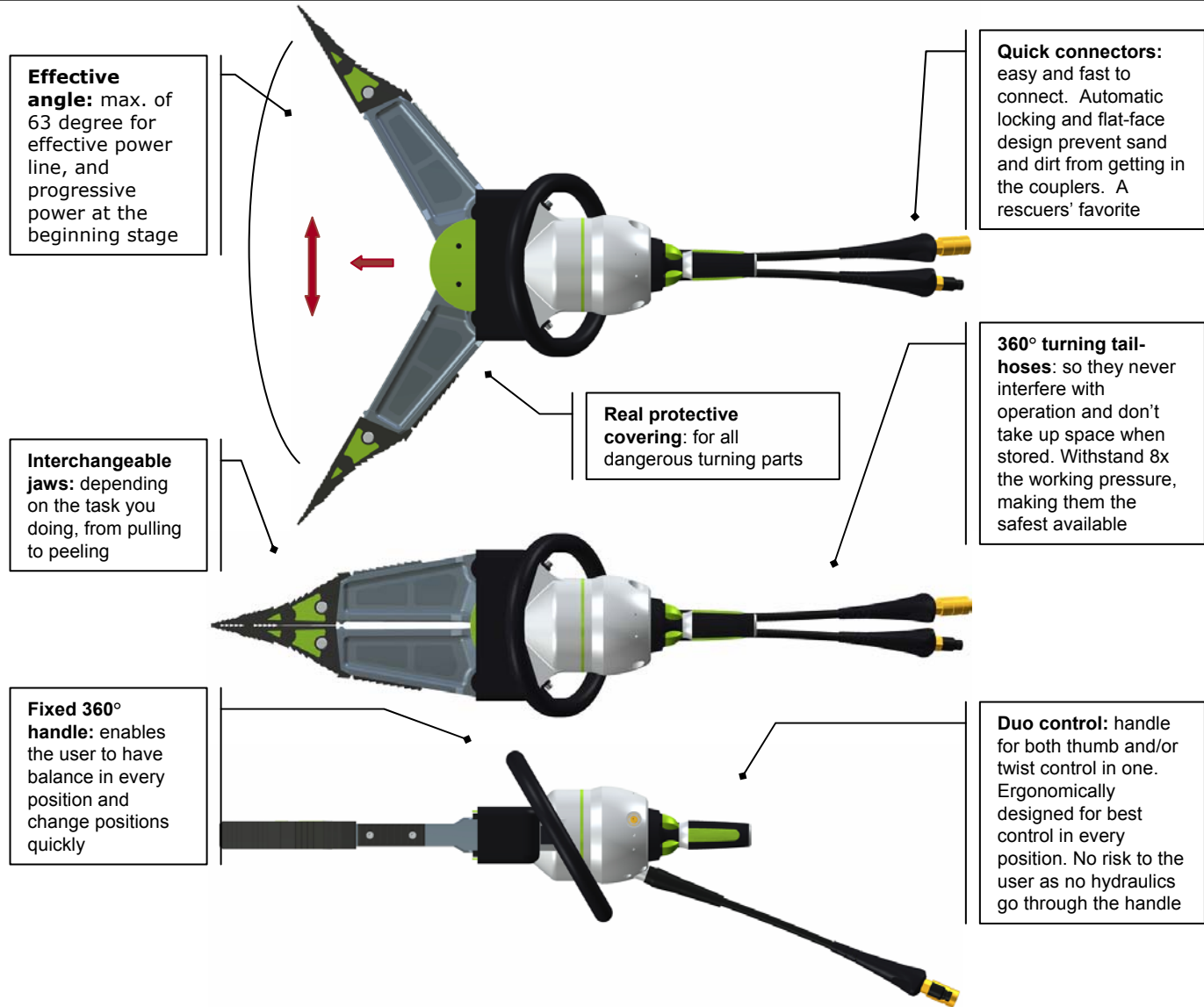

Spreader X-series

## Technical specifications X4s

Model	X4s Spreader
Nominal pressure	UltimatePSI™ / 5000 PSI / 350 Bar
Dimensions (LxWxH)	33 11/16" x 11 7/16" x 10 7/8" // 855 x 290 x 277 mm
Operational weight	48.3 lb / 21.9 kg
Max. spreading opening	31 3/4" / 806 mm
Spreading force	226,980 lbs / 113.5 US tons / 1010 kN / 103 ton
Spreading force 25 mm of tips	33.9 upto 48.2 kN / 3.8 upto 5.4 US tons
Max. pulling opening	20 13/16" / 529 mm
Max. pulling force	16,383 lbs / 8.2 US tons / 72.9 kN / 7.4 ton
EN 13204	Compliant
NFPA 1936	Compliant

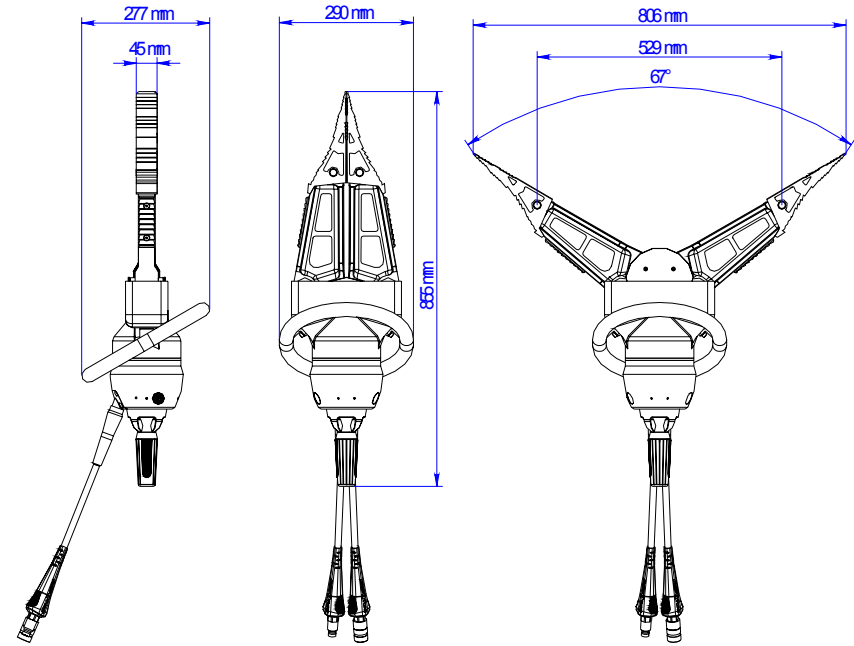

For questions or additional information please e-mail to [info@resqtec.pl](mailto:info@resqtec.pl) / [info@ratownictwo.com.pl](mailto:info@ratownictwo.com.pl)

DS013K00

**RESQTEC®**

RESQTEC® is a registered trademark

© RESQTEC® 2007  
Technical modifications reserved

P.T.H."COMPART" - Z.Dziembowski, Centrum Sprzetu Ratowniczego  
PL 44-121 Gliwice , ul. Gen.J.Sowinskiego 5 (IMN)  
Tel./ Fax +48 (0) 32 - 2 380 680 , 2 380 436 , e-mail : [info@resqtec.pl](mailto:info@resqtec.pl)  
[www.resqtec.pl](http://www.resqtec.pl) / [www.ratownictwo.com.pl](http://www.ratownictwo.com.pl) / [www.998.info.pl](http://www.998.info.pl)